



VIKING WATER

3 kW | Diesel heater

Power:	900-3000 W (3,070-10,250 BTU)
Fuel:	Diesel, HVO
Operating Voltage:	12 V
Fuel Consumption:	0,10-0,30 l/t (3.4-10 oz/hr)
Electricity Consumption:	0.6-1,0 A
Weight:	10.5 kg (23 lbs)



Wallas Viking Water is a water heating system, which can be used solely for heating domestic fresh water or it can also be used to power up floor and radiator heating. Underfloor heating system distributes pleasant heat evenly in the cabin and requires less fuel and amps than air heaters. With the Wallas Remote App, the heater can be turned on remotely allowing you to enjoy hot water and a warm boat immediately when you arrive at the marina. Viking Water is an excellent option for other off-grid applications as well, for instance, camper vans, cottages, office/break room containers, or construction trailers.

3009 ADVANCED

Thermo | Intelligent Control Panel



- The **Thermostat Mode** automatically keeps the room at an even temperature
- **Summertime Mode** allows you to heat only the hot shower water system without heating the space
- The simple display shows all relevant information at one glance
- Both coolant and hot water targets can be set separately

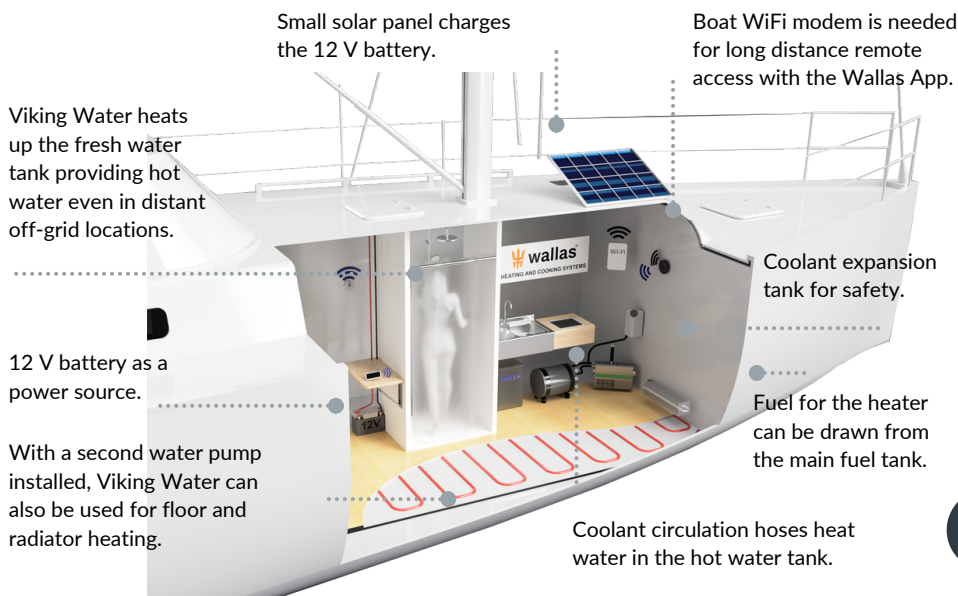

Excellent water heating system for remote off-grid locations

Very low fuel and power consumption

Ultra-low emissions

INSTALLATION

Easy installation can be done independently or by a Wallas professional.

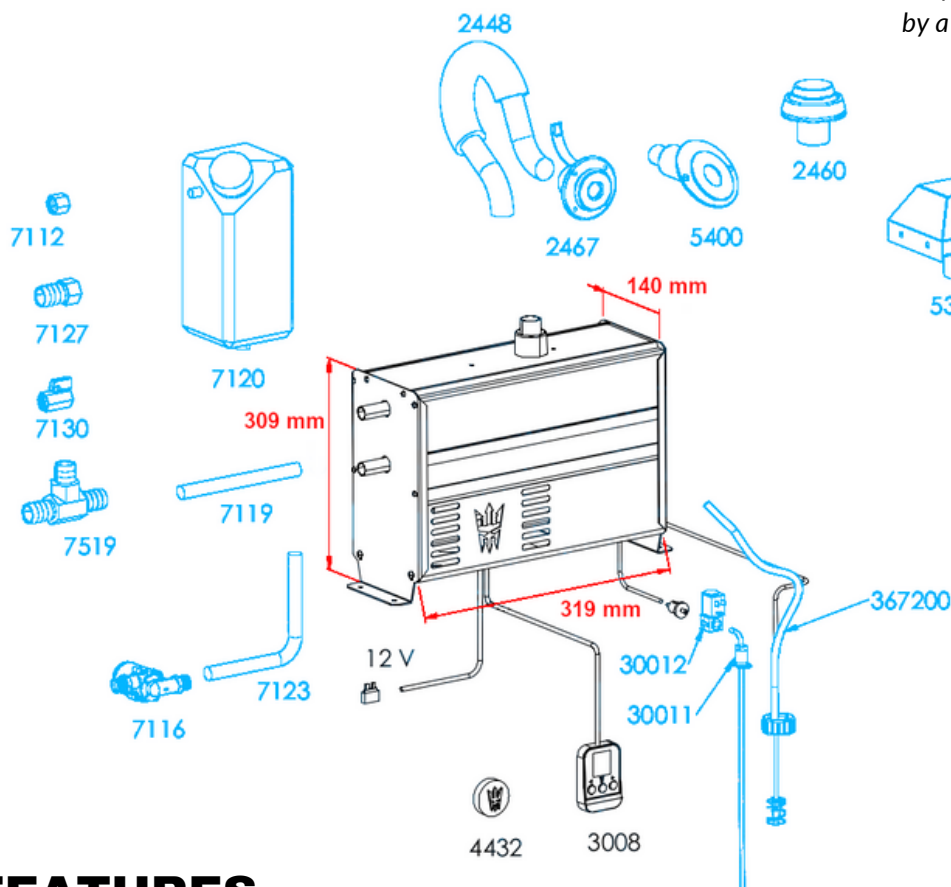

Wireless temperature sensor monitors cabin temperature with improved accuracy and flexibility.

Recommended Builds

Boats 7-9 m (22-29 ft)

Camper Vans: MB Vito

Trailers, Containers 4-6 m, (13-19 ft)

FEATURES

- Advanced Control Panel enables intelligent temperature control.
- Wireless temperature sensing for improved accuracy.
- Fully enclosed laminar combustion is a safe burning process with no exposed flame.
- Delivers heat to a hot water tank and/or floor and radiator heating.
- Floor heating dispenses even heat to the indoor space and provides the added comfort of warm floors under your feet.
- No burning hot heater grilles for everyone's safety.
- Brushless motors have a very long life-cycle, supporting reliably long service intervals.
- Made of stainless steel, high-grade aluminum, and other corrosion-resistant materials.
- Warranty 2+1 years.
- E-mark approved for vehicles.



{Accessories in black come with the standard package. Accessories in blue are additional/optional. Wallas-Marin reserves the right to change or improve its products and to make changes in the content of this brochure without obligation to notify any person or organization of such changes or improvements. Go to www.wallas.fi for current updates and supplemental information concerning these products.

wallas.fi